



Application for Fireworks Permit

Johnson County Board of Supervisors
913 South Dubuque Street
Iowa City, Iowa 52240-4273
Phone: 319-356-6000
Email: applications@johnsoncountyiowa.gov
www.johnsoncountyiowa.gov/fireworks

RECEIVED

JUN 05 2024

Board of Supervisors

Completed applications should be submitted to the Board Office at least 14 days before the anticipated display.

Applicant information (municipality, organization, or group of individuals)

Name: BRIEN WHITFORD
Address: 3791 COTTAGE RESERVE ROAD, Solon 52333
Telephone number: 404-932-7030
Email: BRIENWHITFORD@GMAIL.COM
Contact person: BRIEN WHITFORD

Display information

Type of fireworks display (See Johnson County Ordinance No. 03-28-13-01 for definitions.):

Consumer fireworks (Class C, 1.4G) Display fireworks (Class B, 1.3G)
Date of fireworks display*: 7/3/24 Rain date of fireworks display: 7/5/24
Start time of fireworks display: 9:30pm End time of fireworks display: 10:15pm

Location of fireworks display. A copy of drawing must be attached, and must be labeled with the following:

The drawing must contain the shoot site and drop zone, including their distance from spectators and any building. Refer to Johnson County's Property Information Viewer (PIV) at <https://www.johnsoncountyiowa.gov/gis/property-information-viewer> to obtain a location map and parcel number.

Physical address of display: 3550 HIGHWAY 382 NE, Solon, IA 52333
PIV parcel number: # 0229 276001

Operator information

Name: JPM DISPLAYS INC.
Address: 18064 170TH AVENUE, YARMOUTH, IA 52660
Telephone number: 319-394-2670
Operator is 21 years of age or older? Yes No

* It is recommended that applicants notify their local fire department and the Johnson County Sheriff's Office prior to the date of the display.

* In the event a burn ban is issued for Johnson County by the State Fire Marshall or other appropriate authority, all permits granted shall be automatically suspended until such time as the burn ban is lifted.

Certification (A copy of current certifications must be attached):

Any applicant requesting a permit for a display of Class B display fireworks shall have an operator who possesses a current and valid ATF permit as set forth by the Safe Explosives Act and is certified by a nationally-recognized fireworks safety organization such as the American Fireworks Association (AFA) or the Pyrotechnics Guild International, Inc. (PGI). Any applicant requesting a permit for a display of Class C consumer fireworks shall have an operator who is certified by a nationally-recognized fireworks safety organization such as the AFA or PGI.

AFA certification number or current PGI card/certificate: _____

ATF permit number: 5-IA-057-51-4K-00059

Other basis of proficiency (Specify): _____

Insurance (Copies of proof of insurance must be attached.):

Proof of insurance for a display of "consumer fireworks"

Bond or proof of insurance in an amount not less than \$1,000,000 for a display of "display fireworks"

Proof of workers compensation insurance, where appropriate

I hereby affirm that I have read Johnson County Ordinance No. 03-28-13-01 governing issuance of fireworks permits; that I understand the ordinance's terms; and that I will conduct myself according to its terms, the conditions of this permit, and the laws of the State of Iowa.

Further, as the applicant or as a duly authorized representative of the applicant on its behalf, I hereby agree to protect, defend and hold Johnson County, and its employees and officers, harmless from any and all damages, expenses, claims or any other liabilities that may arise or accrue by reason of the granting of this permit or the activities authorized hereunder.

Signature of applicant or operator

5/24/24

Date

For office use only

Date complete application received: 6/5/24

Application complete:

Yes

No, list application deficiencies: 6/5: need certification by nationally recognized fireworks safety organization such as AFA or PGI. ✓ received 6/5/24

Application fee of \$40 received (cash or check only): Yes No

Date targeted for Board discussion: 6/12/24 Date targeted for Board consideration: 6/20/24

Approved by the Johnson County Board of Supervisors:

Chairperson signature

Date of approval

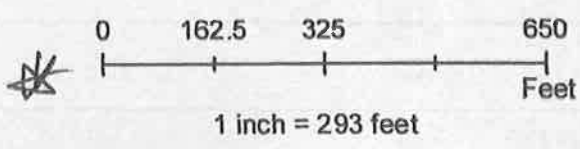
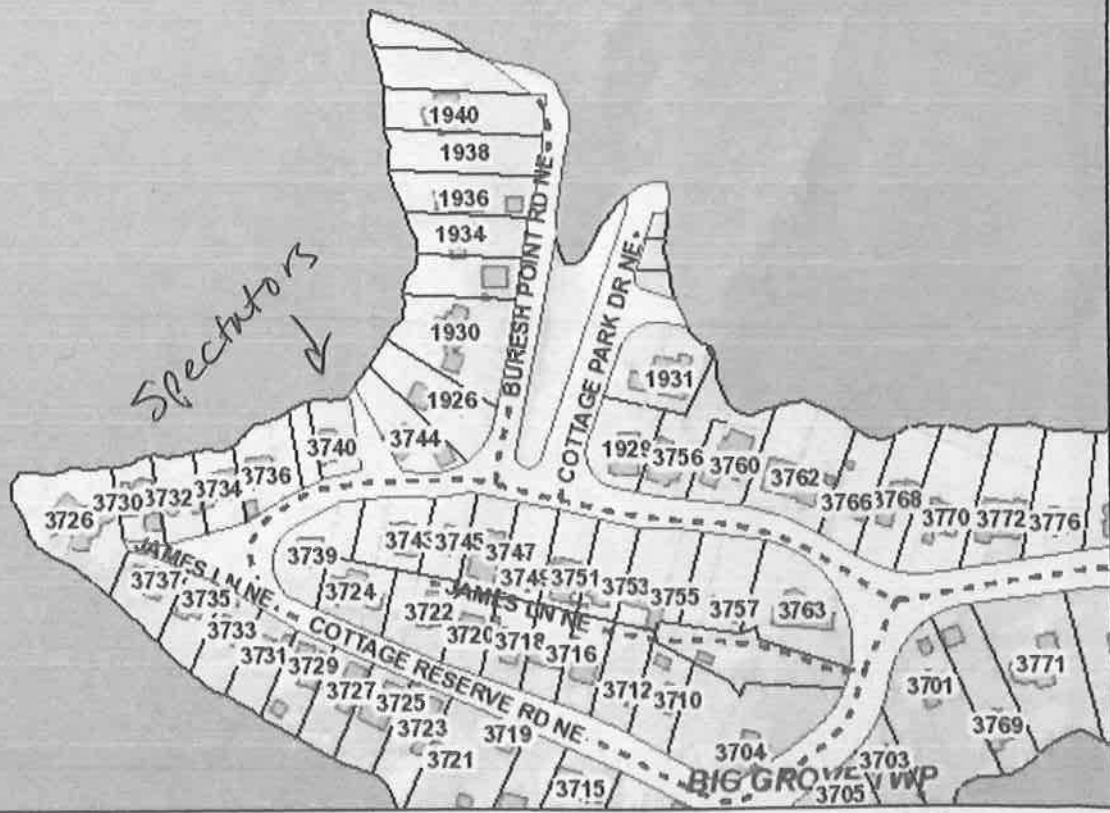
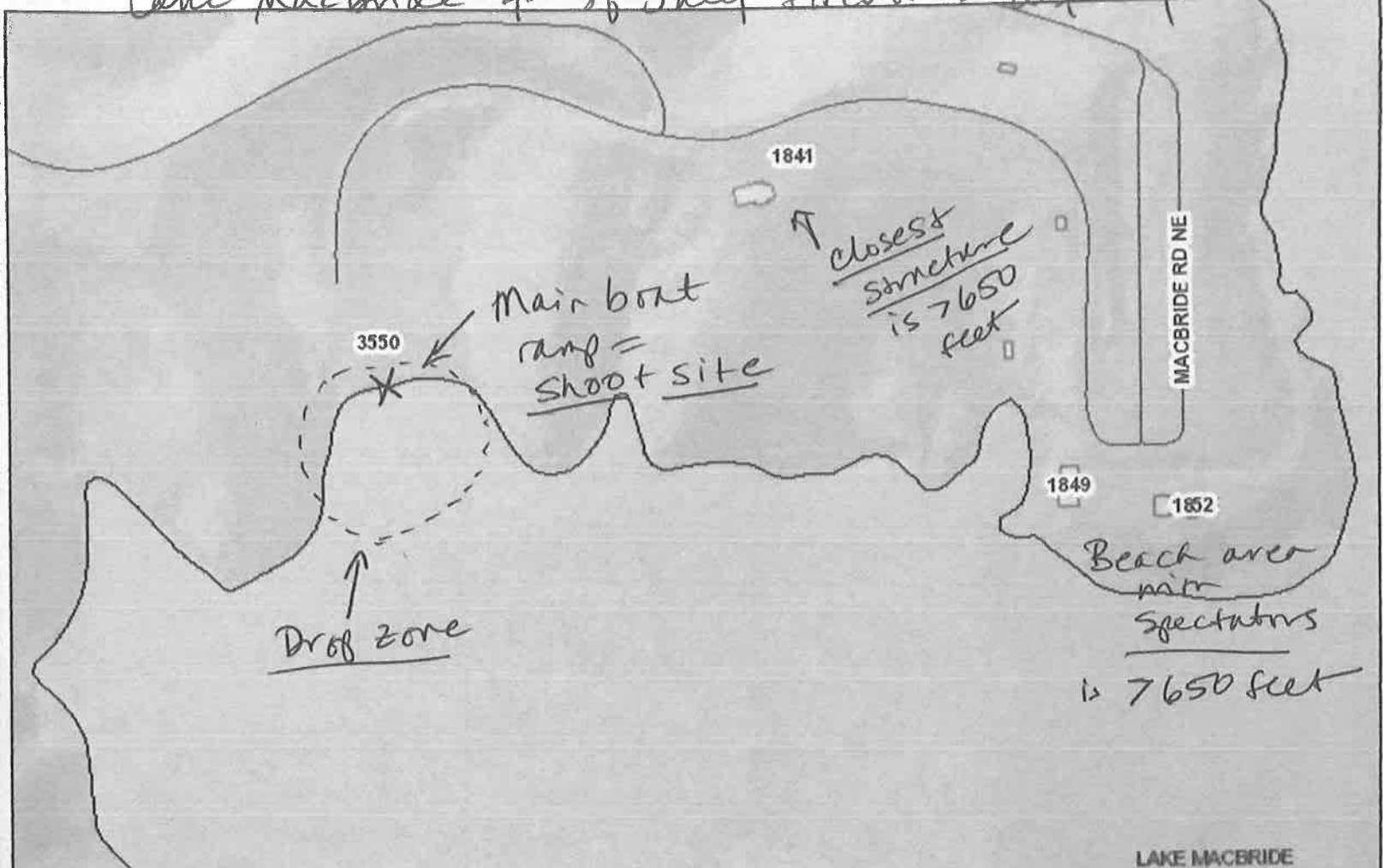

The information presented herein is intended to be an accurate representation of existing records. Johnson County assumes no liability for errors or omissions. Users relying on this information do so at their own risk.

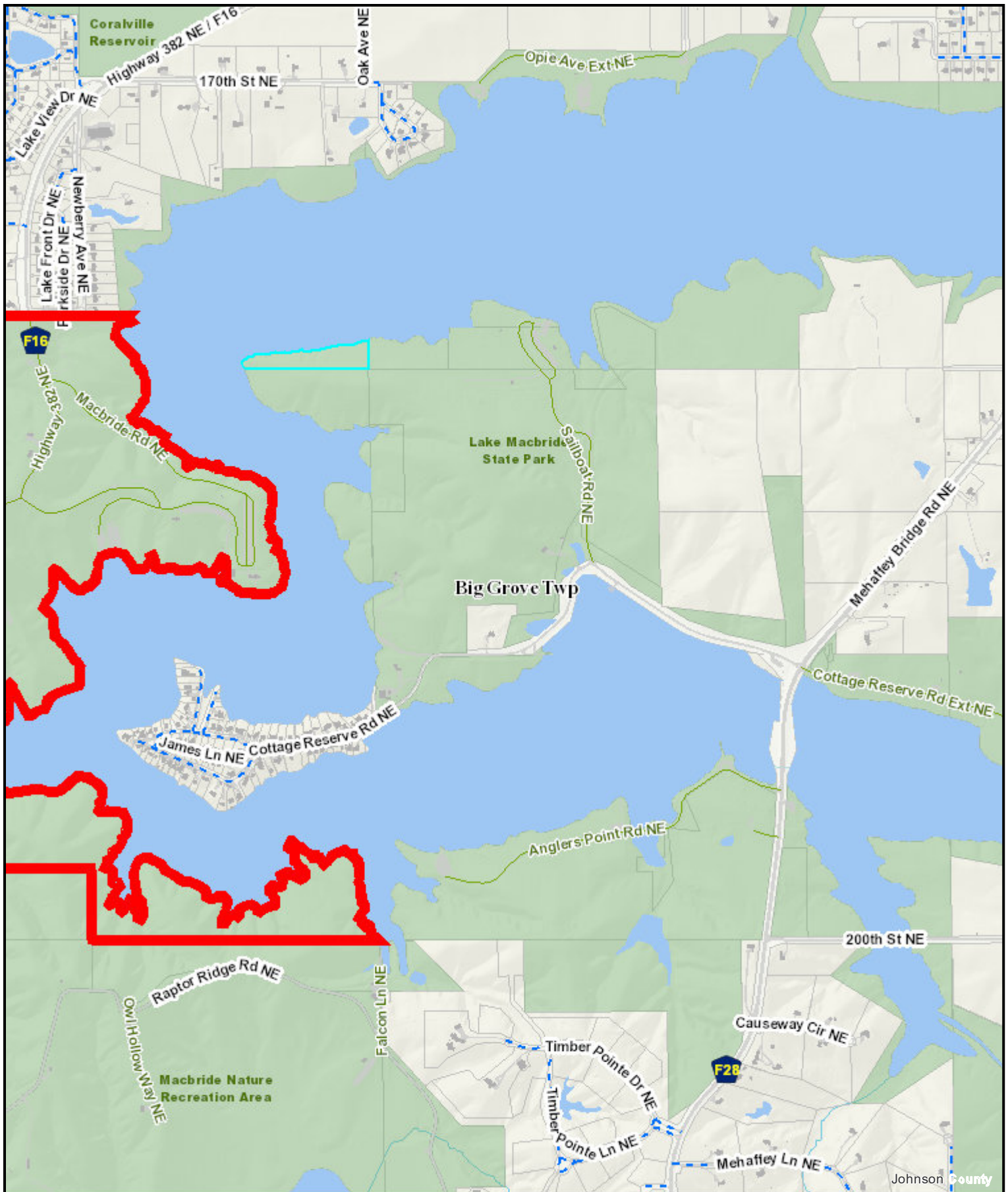

Johnson County GIS
Web Printing

My Map

Printed: 6/6/2022

Parcel #0229276001, 3550 Highway 382 NE, Solon

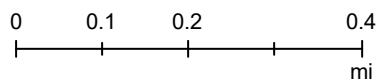

1 inch = 1,172 feet



The information presented herein is intended to be an accurate representation of existing records. Johnson County assumes no liability for errors or omissions. Users relying on this information do so at their own risk.